

Chicago Industrial Pump Company



822 Schneider Drive
 South Elgin, IL 60177
 Ph: 847-214-8988
 Fax: 847-214-8998

INSIDE THIS ISSUE:

Flo-Line Display Tank	1
Oil Separators	2
Self Priming & Flow Inducement	3
Flo-Line Display Tank Pictures	4

Flo-Line Asks “Rubber Ducky or Rubber Chicken”?

Flo-Line Technology, Inc. dives into Pitbull distribution by building their own display tank for their **PITBULL** demo pump. Inspired by the impact of seeing the Pitbull in action on the Pitbull video, Flo-line wanted to go one step further and show the pump working first hand. As seen here, they opted for rubber ducks and a rubber rodent for a twist on our demo video’s rubber chickens and rope. I would like to thank Joseph Well for allowing me to share these pictures with you.

“Great job on the tank, Joe.”

(Additional pictures are located on page 4.)



“Any piece of knowledge I acquire today has a value at this moment exactly proportioned to my skill to deal with it. Tomorrow, when I know more, I recall that piece of knowledge and use it better.”

Mark Van Doren



Remember if you don’t have a demo pump available for viewing the next best thing is the **PITBULL** demo video.

This Video is located on our promo CD or 24 hrs a day on our website at:

www.pitbullpumps.com.

Fast Facts:

You can get live technical assistance for your **Pitbull** pump by calling:

847-214-8988 Ext 12

7:30-3:30 CST

Troubleshooting information and Manuals are available for review or download 24 hrs a day 365 days a year at

www.pitbullpumps.com

PITBULL® CREATES AN OIL WATER SEPARATOR OUT OF CONVENTIONAL PITBULL PUMPS

Overview: Shown are two **PITBULL®** pumps in standard 'gravity fed' mode. They will only cycle when their pump chambers are filled. This requires the liquid level outside the pump to be near the top of the pump chamber (as shown with dotted line). The 'water' pump fills from deep in the sump, taking in only water but cannot fill completely enough to cycle

Key point – The Pitbull can run in such a shear sensitive mode that it will not emulsify free phase liquids, making it perfect for separation processes.

Our pumps are even certified for pumping live organisms.

Water pump fills from lower in the sump via pipe leg. (It holds the water level right at its 'trip point')

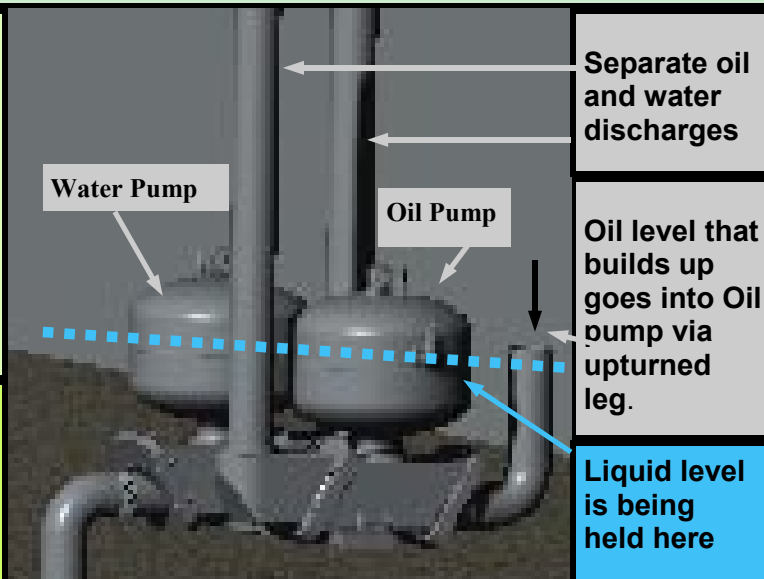

The pumps are not pulling suction, but run instead by gravity. This keeps them from upsetting the hydraulics of oil/water separation as virtually all other pumps will.

Oil coming into the sump will float on the surface in a layer that becomes thicker as it collects until it builds up to the 'oil' pump intake (just slightly above the 'dotted' operating level being held in the sump). From this condition forward, any oil coming into the sump carries over into the 'oil' pump intake and any water sinks and is picked up by the 'water' pump.

The key concept here is that the pumps are not pulling suction, but run instead by gravity. This keeps them from upsetting the hydraulics of oil/water separation as virtually all other pumps will. In addition, the **PITBULL®** pump is extremely gentle and non-shearing on fluids, minimizing emulsion and dissolved content. Our pumps are even certified for pumping live organisms.

Using this configuration allows almost any pit or tank to be used as a separator, and when applied to a free standing tank the pumps need only to be connected to the overflow legs to give 100 psi discharge pressure capacity to a gravity driven process.

The **PITBULL® pump is extremely gentle and non-shearing on fluids, minimizing emulsion and dissolved content.**

PITBULL® Pumps With Enhanced Flow Options Self-priming and Flow Inducement

Any **PITBULL®** pump that is normally gravity fed can be modified to run either in a **flow induced** (submersed pumps) or **self-priming** (dry piped) mode to increase its solids handling, viscosity, low level or suction lift capabilities. By adding the flow inducer option (or vacuum generator, the terms are interchangeable) the **PITBULL®** can pull liquids and solids into it with up to 20"/508 mm Hg of suction force.

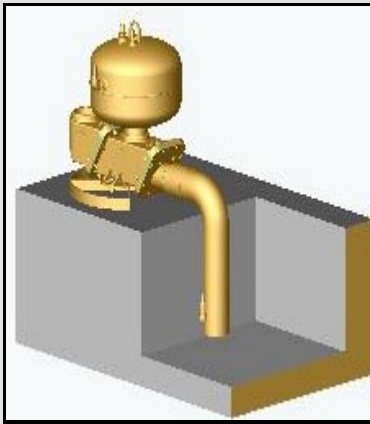

Self-priming with suction lift

CIPC offers vacuum pump options in a variety of flow and vacuum levels to address many application requirements.

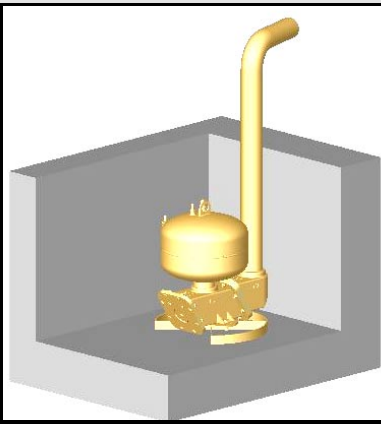

Submersed with flow inducement

How the PITBULL® creates suction: Instead of putting a component into the liquid, our pump uses an extremely simple vacuum device added to the control panel, away from the liquid. This vacuum unit pulls air out of the pump chamber, causing it (the chamber) to suck fluid in like a vacuum truck or shop vacuum.

The Device: In keeping with the **PITBULL®** theme of rugged simplicity our vacuum pumps have no moving parts. The vacuum is created using the venturi principle. A typical unit (Model F2) is shown both solid and cutaway. Compressed air is fed through a nozzle in the top, reaching extremely high velocity where it then exits into the bore. The velocity causes a drop in pressure and at that location a side port is added to allow air to be pulled into the low pressure (vacuum) of the bore.

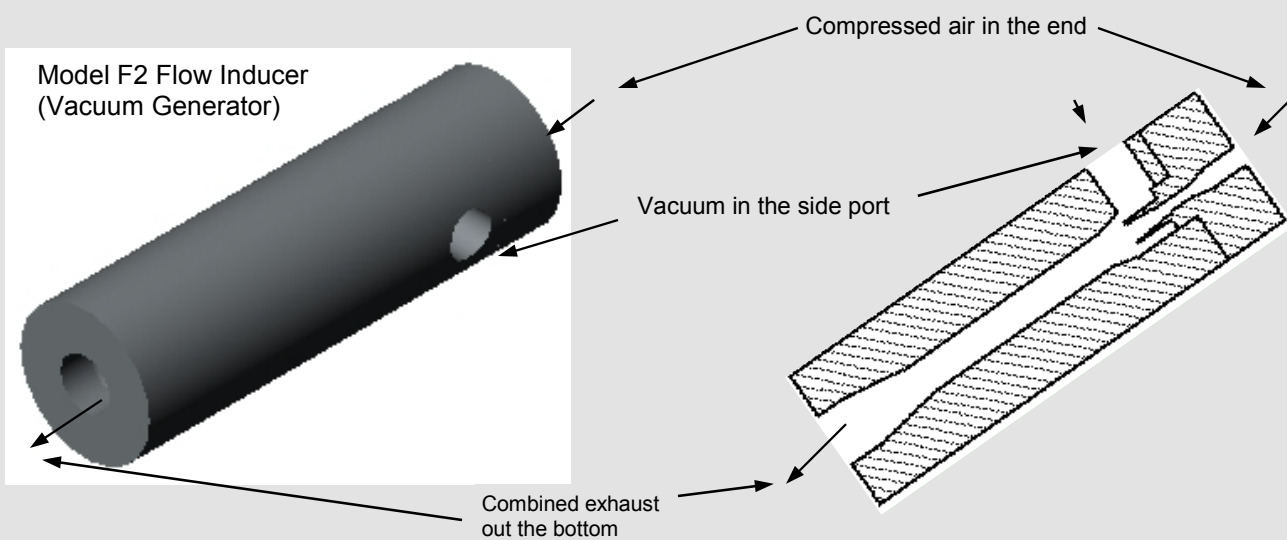

By adding the flow inducer option (or vacuum generator, the terms are interchangeable) the **PITBULL®** can pull liquids and solids into it with up to 20"/508 mm Hg of suction force.

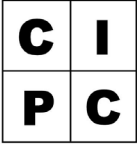

CIPC
822 Schneider Drive
South Elgin, IL
60177

Phone: 847-214-8988

Support Ext. 12

Sales: Ext. 10

Fax: 847-214-8998

Toll free: 1-888-4Pitbull

Email:

Sales@pitbullpumps.com



- Have a PITBULL success story you would like to share?
- Have a suggestion for an article you would like to see in a future issue?
- Want to add to or remove an email address from the PIT BULLETin mailing list?

Email me at RSutherland@pitbullpumps.com

You and your company could be featured in an upcoming issue.

Roger Sutherland - Operations Manager

Additional pictures of Flo-Line's Display tank and Pitbull demo pump.

Be sure to visit us on the web and view the video of the Pitbull in action at:

www.pitbullpumps.com



Home of the
Pitbull Pump
since 1990

